

# Sure Flash Drain Vented System

- 231230 - 12" Sill Flashing
- 330650 - 6" Mesh Tape (Sill Corners)
- 210315 - 3" Flange Extension (Inside Head Flange)
- 200900 - 9" Sure Flash Wrap (No Jamb Fold In)
- or
- 201200 - 12" Sure Flash Wrap (3" Jamb Fold In)
- 330350 - 3" Mesh Tape (Over Jamb Flange)
- 220930 - 9" Adhesive Flashing (Over Head Flange)
- Horseshoe Spacers From Others

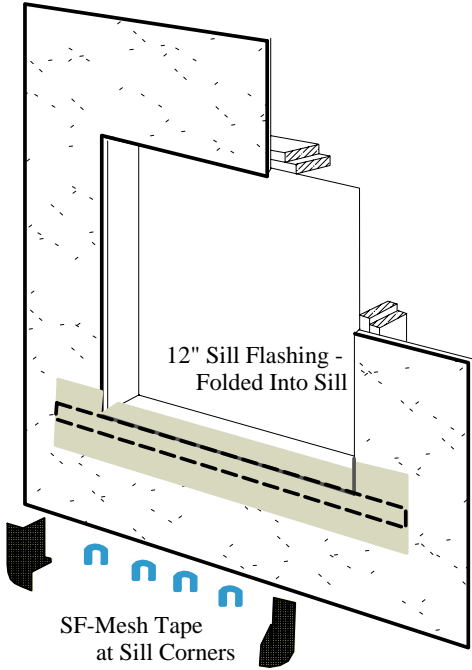
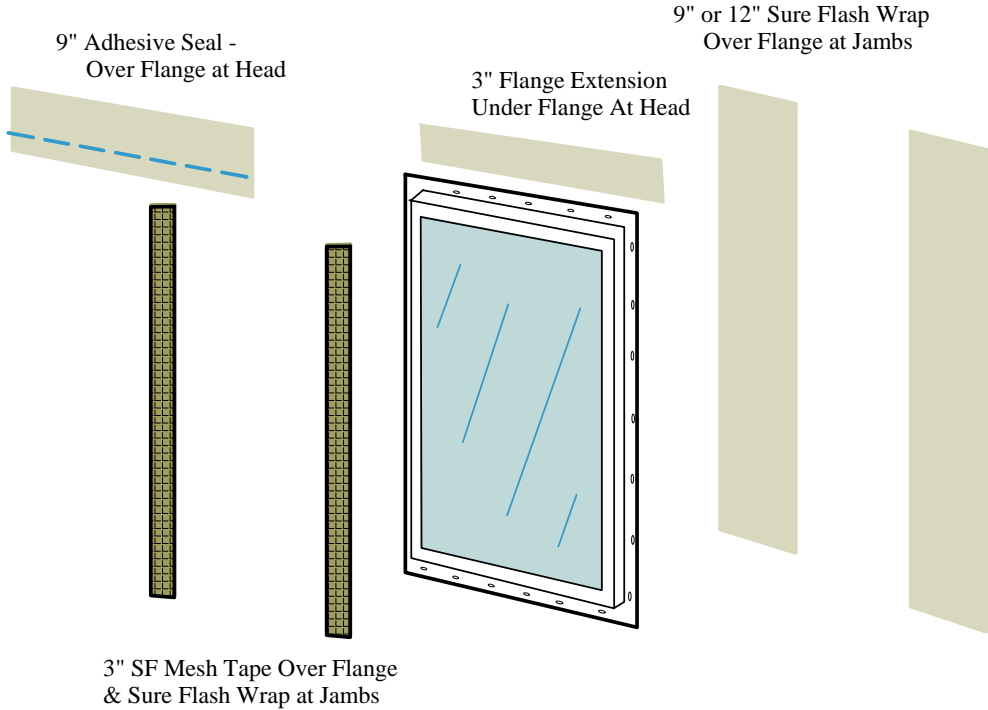

Flashing Products Inc.  
 2319 Federal Avenue East  
 Seattle, Washington 98102  
 www.sureflash.com  
 (206) 568-6633

*Sure Flash - Drain Vented System*  
 10/1/07

- + Prior to window installation any cracked or broken flanges must be repaired or windows replaced.
- + All labels must be removed from flange surfaces.
- + Elongation of flashing fabric at penetrations or tears in flashing must be sealed with caulk or tape.
- + Fasteners for WRB should be sparingly placed around perimeter of flashing.
- + Flange fasteners that are removed or reset must be sealed with caulk.

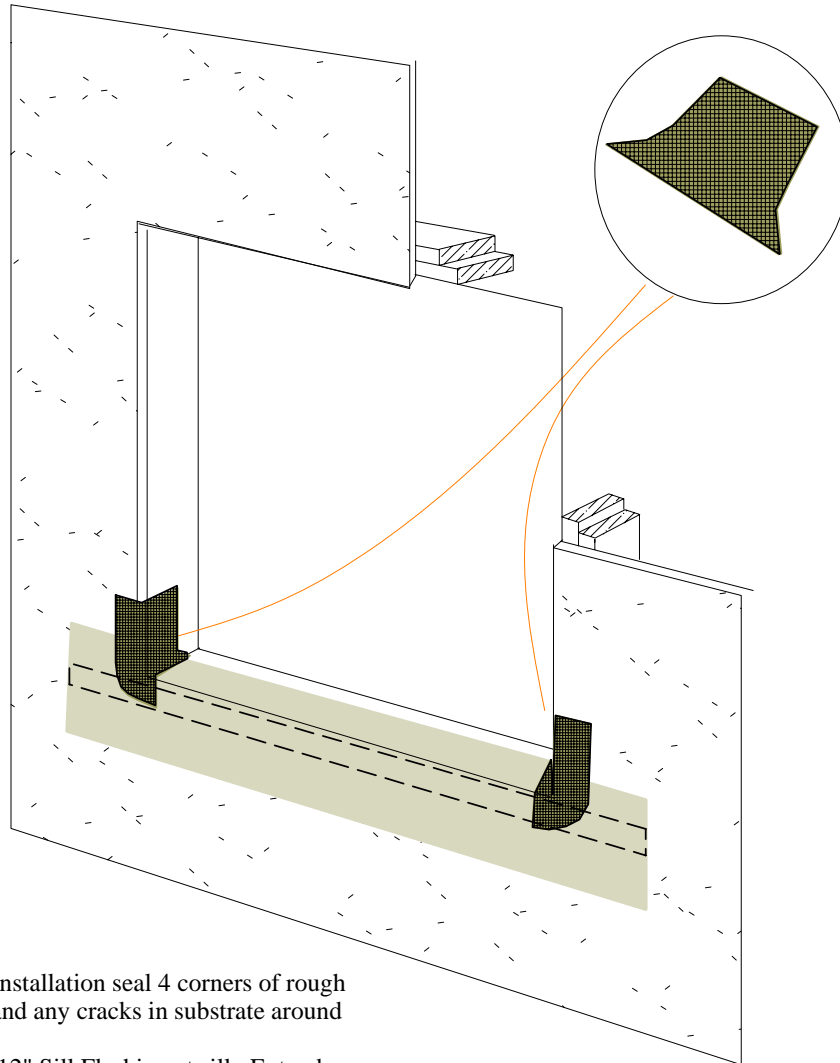

1. Prior to flashing installation seal 4 corners of rough opening with caulk and any cracks in substrate around window opening.
2. Place Sure Flash 12" Sill Flashing at sill. Extend past jambs by 9 inches on both sides of rough opening. Position Sill Flashing so that the adhesive strip aligns with the edge of the sill facing wall. Do not pull release liner. Fasten on one side of opening, stretch across opening and fasten on other.
3. Slit at corners down to sill and fold into rough opening stapling in position in rough opening at flashings edge.
4. Place SF Mesh Tape at each sill corner lapping Sill Flashing 1 1/2", up jambs 3" and onto sheathing at least 2". Pull release liner as tape is positioned, drive out on to wall at 45 angle from corner, then smooth in both directions



Flashing Products Inc.  
 2319 Federal Avenue East  
 Seattle, Washington 98102  
[www.sureflash.com](http://www.sureflash.com)  
 (206) 568-6633

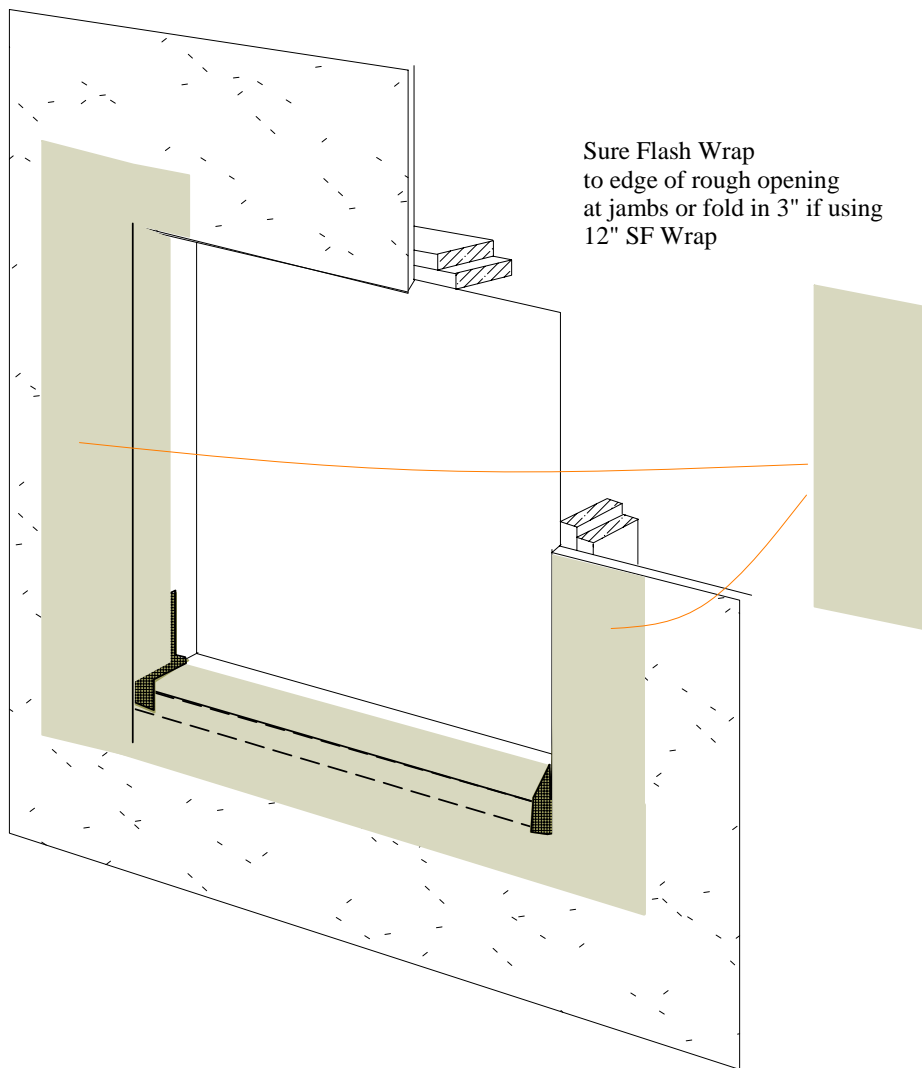

1. Install Sure Flash Wrap at each jamb. Use 9" width or 12" to allow fold into rough opening of 3". Extend 9" above head rough opening and slightly past sill flashing.
2. Fold flap at sill vertically from sill to bottom of jamb flashing, fold to begin 1" away from sill R/O corner. Cut away flap along fold line



Flashing Products Inc.  
 2319 Federal Avenue East  
 Seattle, Washington 98102  
[www.sureflash.com](http://www.sureflash.com)  
 (206) 568-6633

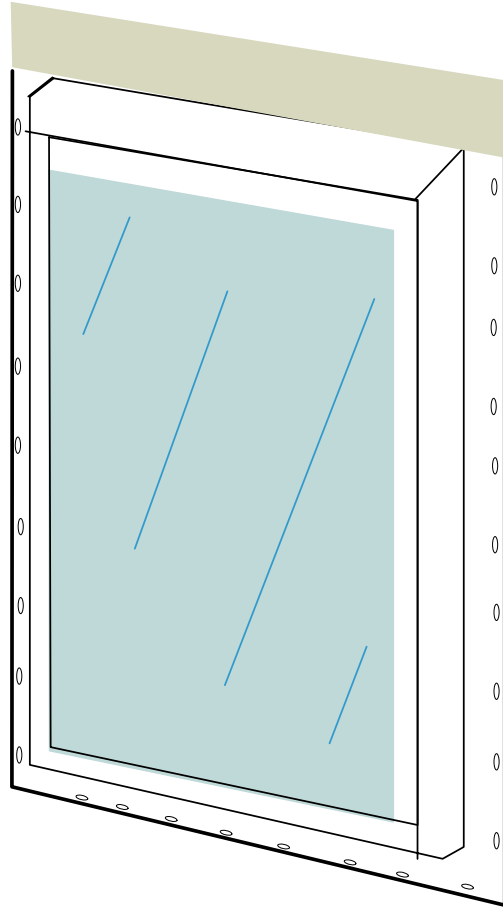
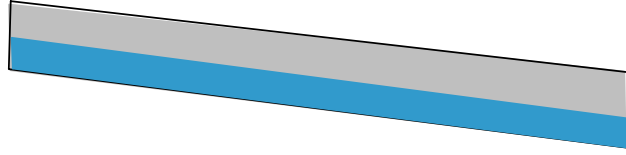

1. Make sure that flange is clean, dry and free of paper labeling.
2. Place 3 inch Flange Extension across inner side of flange at head of window. Touch adhesive at one side and then stretch across touching extension adhesive to flange on the other side. With light pressure compress adhesive to flange and then compress with hard pressure across full width. Cut even to outer edge of jamb flange.



Flashing Products Inc.  
2319 Federal Avenue East  
Seattle, Washington 98102  
[www.sureflash.com](http://www.sureflash.com)  
(206) 568-6633

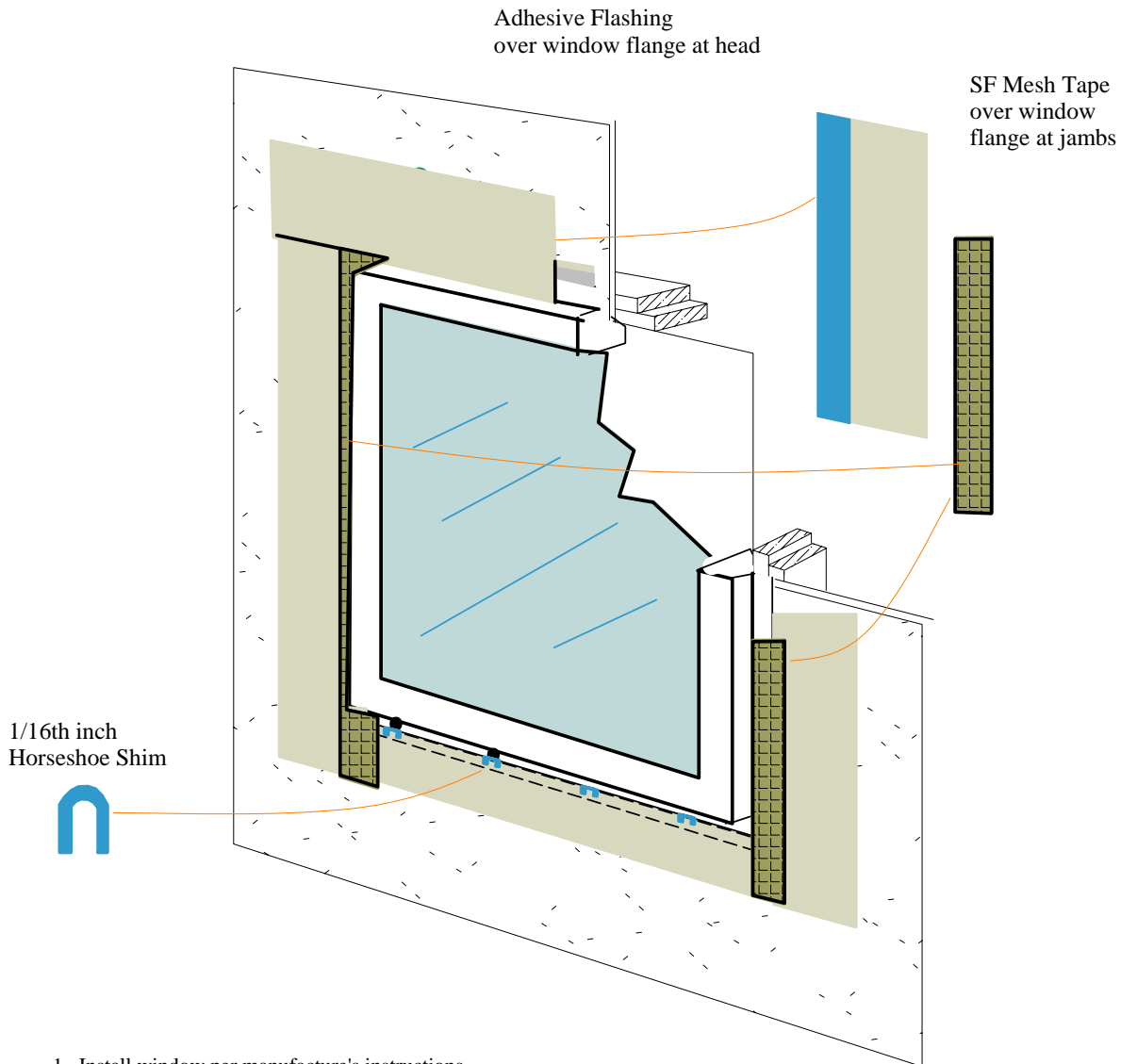

1. Install window per manufacture's instructions.
2. Use 1/4" sill shims at interval across rough opening width. Shim should be 1/4" narrower than window frame inset leaving channel for caulk seal.
3. Make sure window flange and flashing are clean and free of moisture and frost.
4. Place 1/16th" horseshoe spacer under sill flange at 8 - 12" interval.
5. Secure window according to manufacture instructions.
6. Place 2" or 3" SF Mesh Tape over both jamb flanges & fully compress with back of utility knife.
7. Place 9 inch Adhesive Seal at window head. Position over flange and extend just past jamb flashing on each side of window. Pull tight and touch adhesive down on opposite side of window. Compress adhesive lightly full length and then fully compress with blunt tool (back of utility knife).



Flashing Products Inc.  
 2319 Federal Avenue East  
 Seattle, Washington 98102  
[www.sureflash.com](http://www.sureflash.com)  
 (206) 568-6633

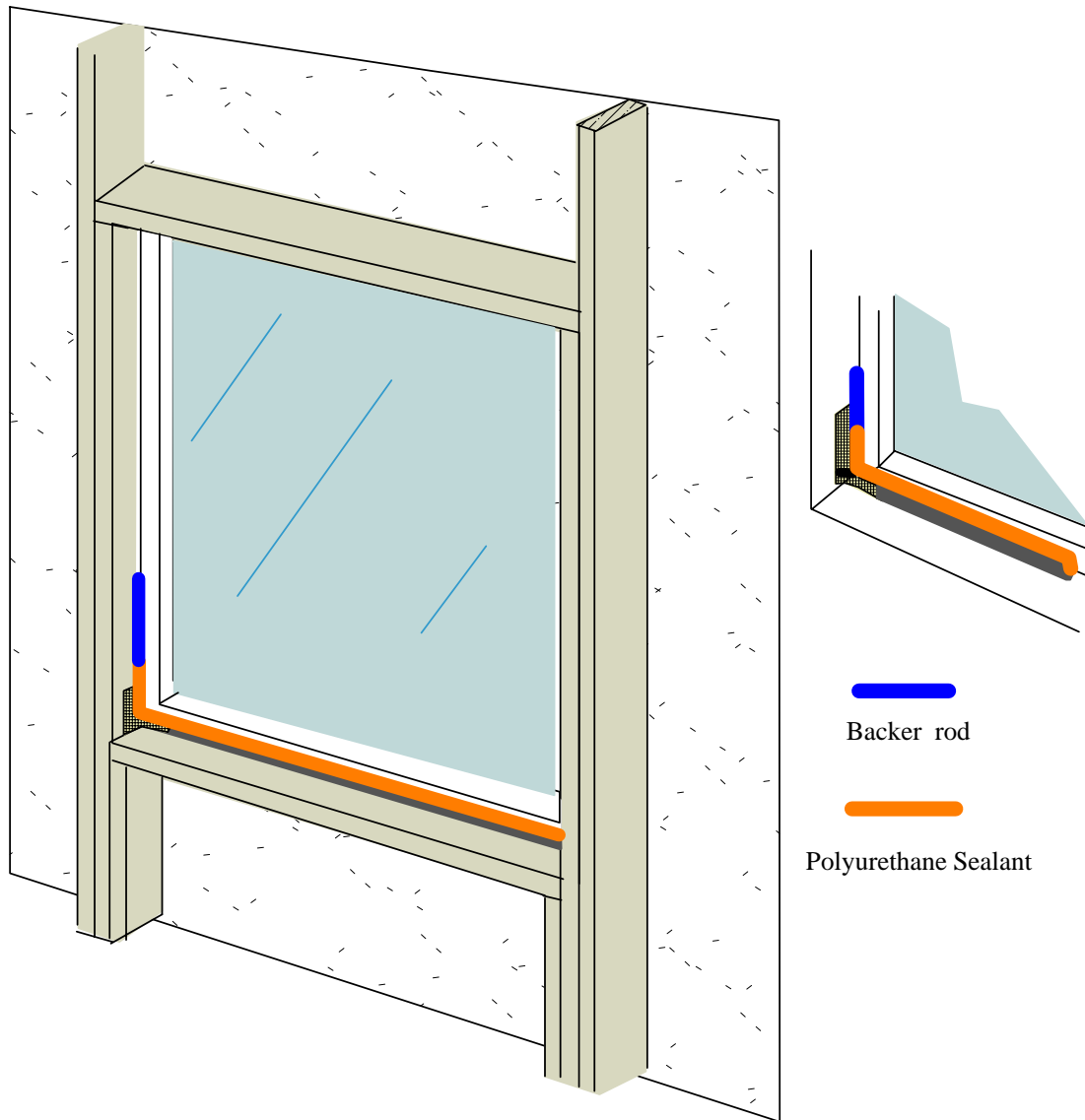

1. Place backer rod across sill between shims and at both jambs in rough opening gap. Extend from sill up jamb at least 3". Fill gap at sill and up jamb with polyurethane sealant. Tool in place for smooth finish.
2. At interior jamb & head air seal full perimeter of window at interface of flashing, window inner frame and framing. This is critical for all sill pan installations.
3. At exterior lap weather resistive barrier under flashing at sill and jambs (when possible) and over flashing at head.
4. Install sloped drip cap above window trim. Drip cap is to extend full width of trim with end dams at both ends.



Flashing Products Inc.  
 2319 Federal Avenue East  
 Seattle, Washington 98102  
[www.sureflash.com](http://www.sureflash.com)  
 (206) 568-6633