

# Sure Flash - Sill Pan Plus

Effective 06/29/09

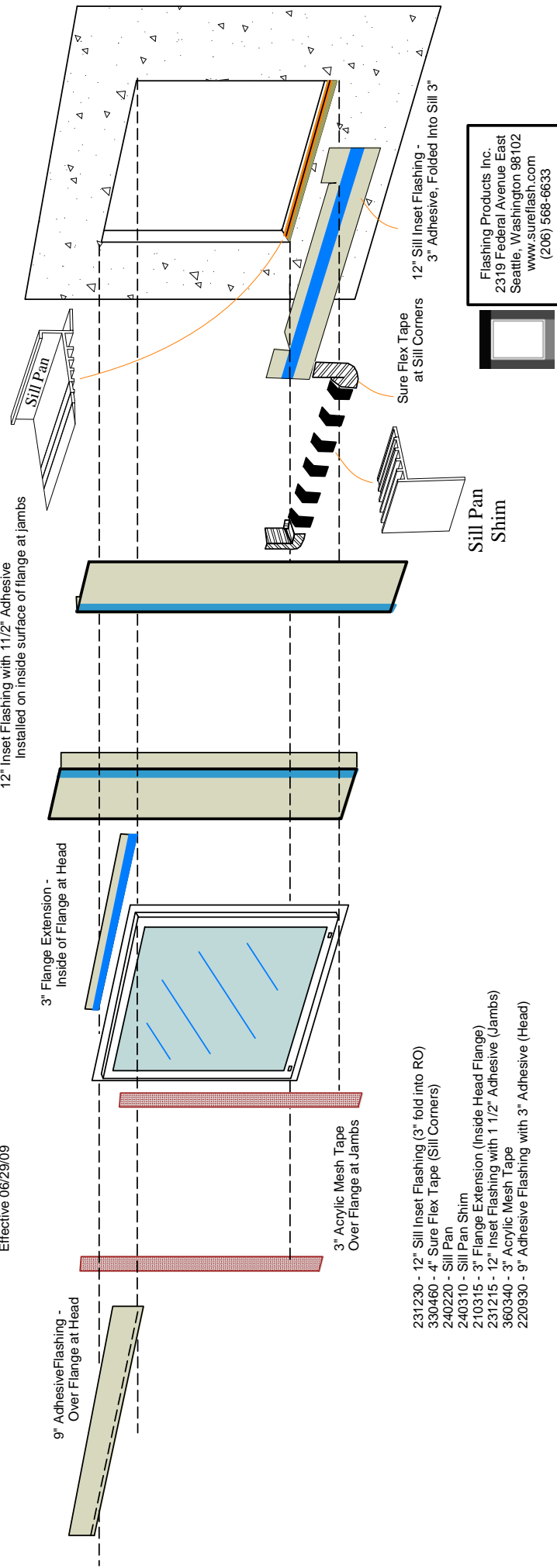

- 231230 - 12" Sill Inset Flashing (3" fold into RO)
- 330460 - 4" Sure Flex Tape (Sill Corners)
- 240220 - Sill Pan
- 240310 - Sill Pan Shim
- 210315 - 3" Flange Extension (Inside Head Flange)
- 231215 - 12" Inset Flashing with 1 1/2" Adhesive (Jamb)
- 360340 - 3" Acrylic Mesh Tape
- 220930 - 9" Adhesive Flashing with 3" Adhesive (Head)

Flashing Products Inc.  
 2319 Federal Avenue East  
 Seattle, Washington 98102  
[www.sureflash.com](http://www.sureflash.com)  
 (206) 568-6633

Flashing Products Inc.  
 2319 Federal Avenue East  
 Seattle, Washington 98102  
 www.sureflash.com  
 (206) 568-6633



*Sure Flash Systems - Sill Pan Plus*

Effective 06/30/09

**Sill Pan - Jamb Cross Section**

1. Window profile
2. 12" Inset Flashing with 1 1/2" Adhesive
3. 3" SF Acrylic Mesh Tape
4. Backer Rod
5. Air Seal

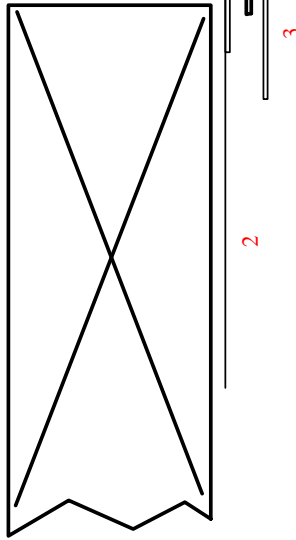

**Sill Pan - Head Cross Section**

1. Window profile
2. 3" Flange Extension or 6" FE if fold in at head is required
3. 9" Adhesive Flashing with 3" Adhesive
4. Air Seal
5. Drip Cap
6. 2" SF Mesh Tape

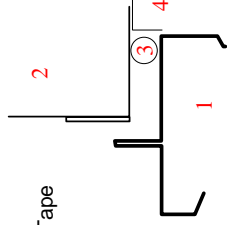

**Sill Pan - Alternate Head Cross Section**

1. Window profile
2. 6" FE if fold in at head is required
3. Backer Rod
4. Air Seal
5. SF 4" Flex Tape Corners at Head ( Not Shown)

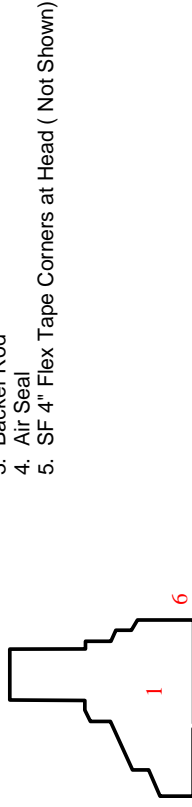

**Sill Pan - Sill Cross Section**

1. Window profile
2. Sill Pan
3. Sill Pan Shirm
4. 12" Sill Flashing with 3" Adhesive
5. Caulk Seal
6. SF 4" Flex Tape Corners at Sill ( Not Shown)

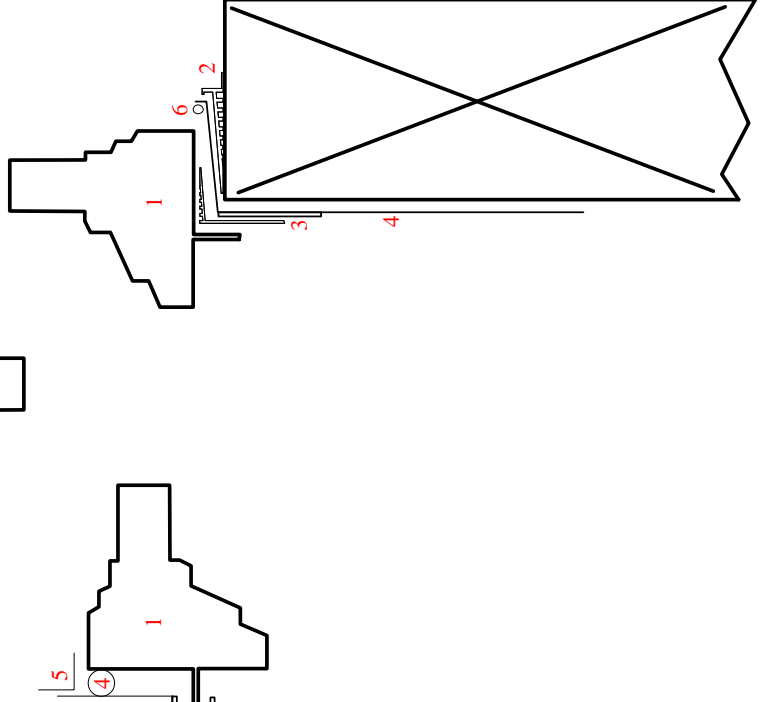

Effective 6/28/09



Flashing Products Inc.  
2319 Federal Avenue East  
Seattle, Washington 98102  
www.sureflash.com  
(206) 568-6633

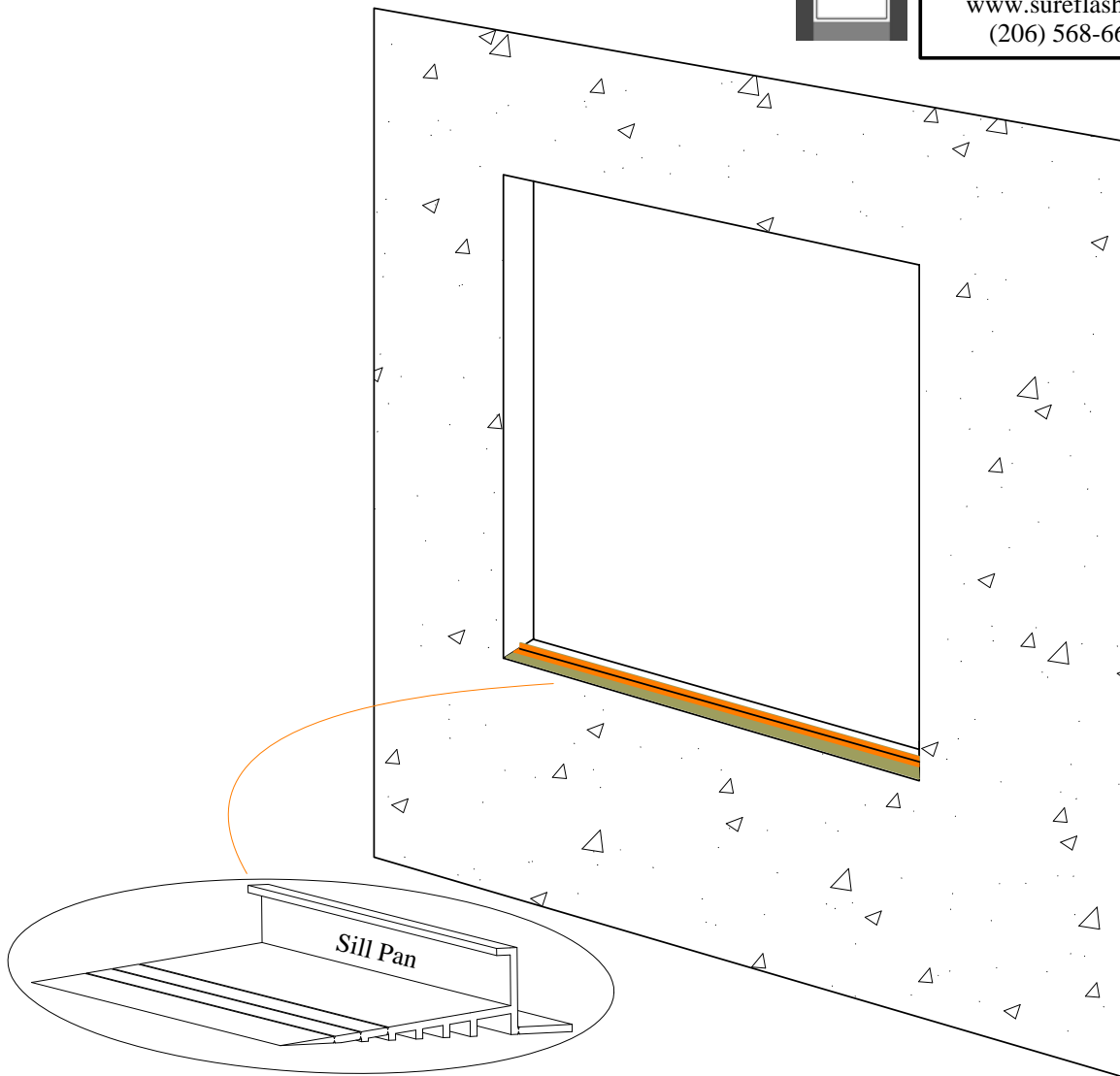

- + Prior to window installation any cracked or broken flanges must be repaired or windows replaced.
- + All labels must be removed from flange surfaces.
- + Elongation of penetrations through flashing or tears in flashing must be sealed with caulk or tape.
- + Fasteners for WRB should be sparingly placed around perimeter of flashing.
- + Adhesives may require from 7 to 10 days to fully cure.
- + Flange fasteners that are removed or reset must first be sealed with caulk.
- + Flashing materials at each side of a window should be a single piece and not spliced together to form a longer section, any section of flashing that has imperfections or damage should be discarded.
- + Shims to under the window flange to level the window vertically on the wall are to be placed between flashing and wall, not between flashing and flange.
- + Adhesives are pressure sensitive and must be compressed into position with blunt instrument such as the end of a retracted utility knife AND roller.
- + Confirm acrylic adhesive adheres to all flange surfaces.

1. Prior to flashing installation seal any significant gaps in rough opening with caulk and any cracks in substrata around window opening to limit air flow to surrounding interior walls.
2. Cut Sill Pan to length of window less 1/4 inch.
3. Determine position sill pan is to be set in window; measure window inset depth, allow 1/16" for shim leg width, Sill Pan is to have no more than 1/16" gap between window and Sill Pan Back Dam. Sill Pan has 3 score lines allowing width adjustment.
4. Position Sill Pan, sloped to building exterior, along edge of sill R/O. Position such that back dam will clear interior side of window frame by 1/16" or less.
5. Fasten with a small screws at 12" - 18" interval in nailing strip of Sill Pan. Nailing strip may be cut off at back dam after caulk has cured.
6. Minor adjustment to pan inset can be made after window installation by removing retention screws, applying pressure to back dam and resetting screws.



Flashing Products Inc.  
2319 Federal Avenue East  
Seattle, Washington 98102  
www.sureflash.com  
(206) 568-6633

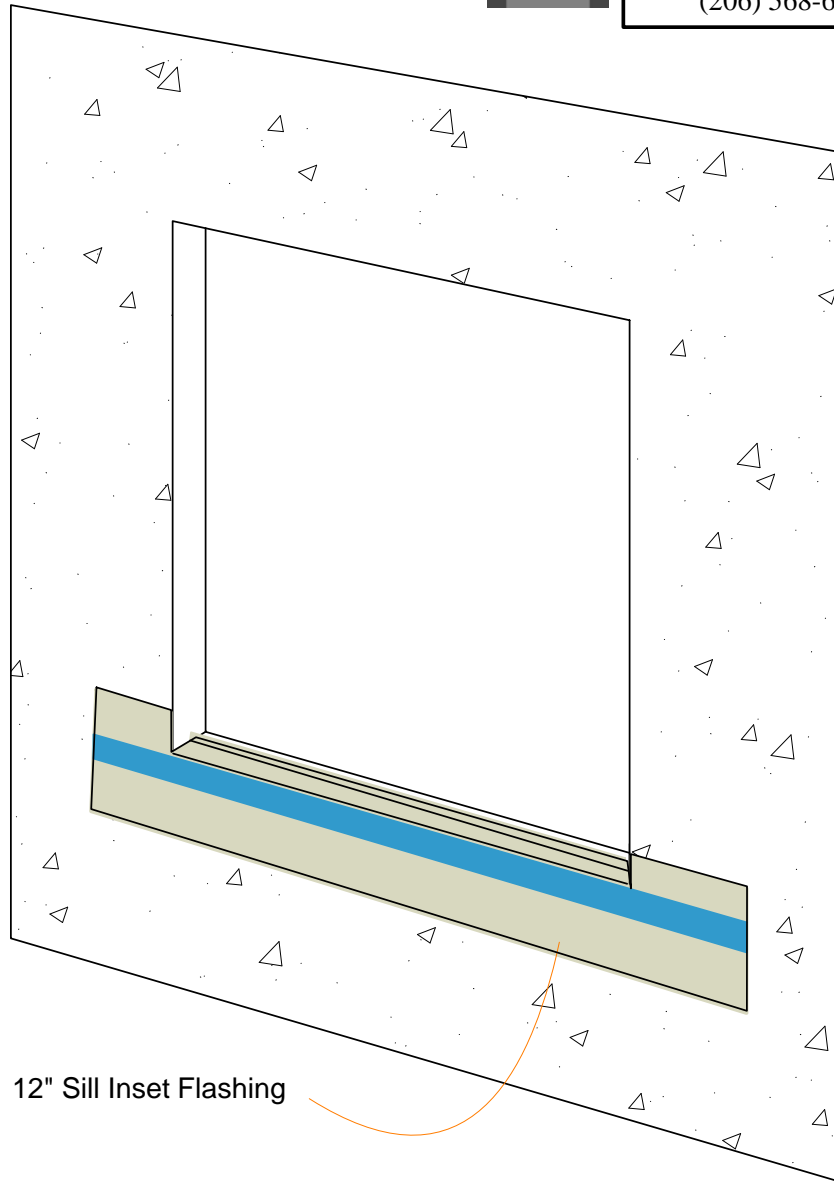

12" Sill Inset Flashing

1. Pull adhesive release liner from Sill Pan.
2. Place 12" Inset Flashing at sill. Extend past jambs by 9 inches on both sides of rough opening.
3. Position Inset Flashing with adhesive strip facing out so that top of adhesive strip aligns with rough opening edge. Do not pull release liner but position top of adhesive strip at rough opening edge. Fasten on one side of opening, stretch across opening and fasten on other.
4. Slit at corners down to sill and fold into rough opening adhering to Sill Pan adhesive strip. Bed flashing into back dam under lip. Cut flashing even with top edge of back dam on Sill Pan.

Effective 06/30/09



Flashing Products Inc.  
2319 Federal Avenue East  
Seattle, Washington 98102  
www.sureflash.com  
(206) 568-6633

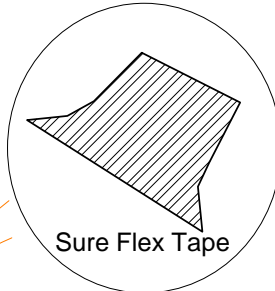

Cut 4" Sure Flex Tape in 5" lengths  
+ 4" width extends into rough opening 2 1/2"  
and 1 1/2" out onto wall  
+ 5" length extends across sill 11/2"  
and up jamb 3 1/2"

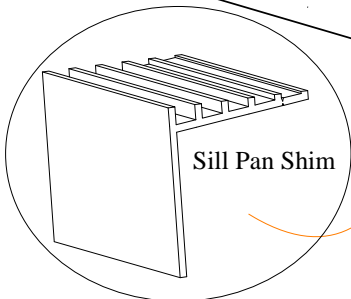
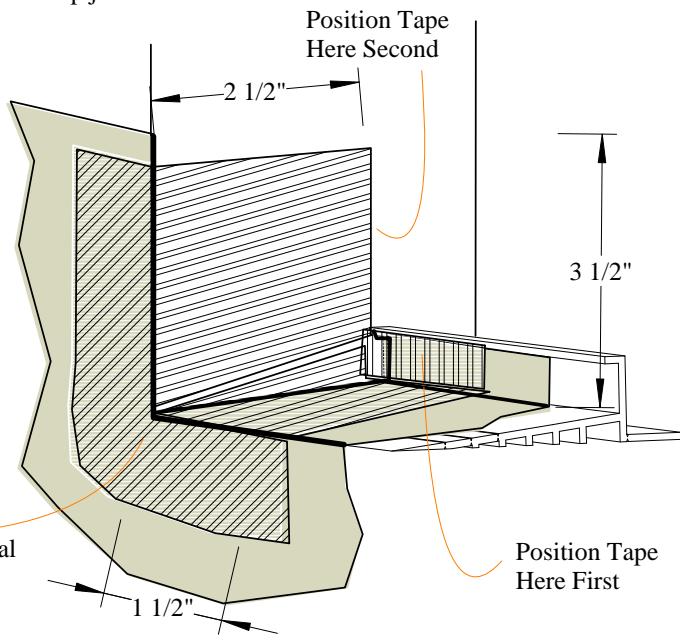

Drive Tape down from corner at 45 degree angle onto wall, then smooth vertical and horizontal

1. Pull Sill Flashing release liner back from each corner to allow placement of corner Sure Flex Tape. Remove from center of opening prior to placing sill shims.
2. Place 4" SureFlex Tape (cut in 5" rectangle) at each back dam corner of Sill Pan and compress adhesive in place. Pull release liner from tape corner to be adhered to back dam first. Position with 1 1/2 inch overlap of Sill Inset Flashing / Pan and so that tape will extend up Jamb at least three inches. Place into corner at back dam with proper alignment to extend up jamb. Tape should extend to top of back dam. Pull remaining release liner, extend up jamb and onto exterior sheathing. Drive tape onto sheathing away from corner at a 45 degree angle, then to outer edges of tape.
3. Compress adhesive in place by firm hand pressure.
4. Prior to window installation pull release liner from Sill Inset Flashing & Sill Shims. Place over Sill Flashing positioning Shims adjacent to Sure Flex Tape at both ends of opening.
5. Position Shims at 6 inch intervals according to window manufacture instructions across rough opening. Place a Shim Block to support all glass support blocks, mullions or joining bars (confirm with window manufacture).

Effective 06/30/09



Flashing Products Inc.  
2319 Federal Avenue East  
Seattle, Washington 98102  
www.sureflash.com  
(206) 568-6633

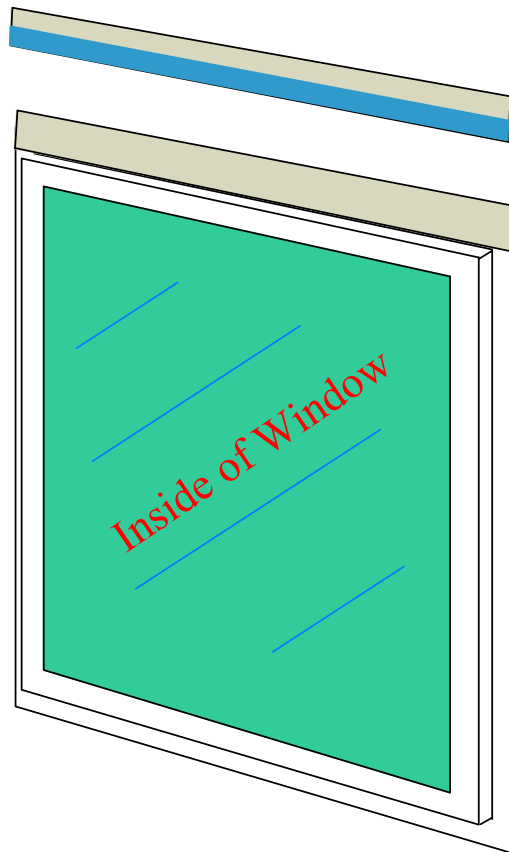

Blue release liner is pulled, adhesive exposed and adhered to inside of window flange.

1. Install 3" Flange Extension at head of window to inside of window flange. Adhesives are to fully cover flange. Apply at one corner, stretch across full width of window, cut to width of window, touch adhesive down at opposite side and compress lightly across full width. Finally firmly compress adhesive across full width of window.

Effective 06/30/09



Flashing Products Inc.  
2319 Federal Avenue East  
Seattle, Washington 98102  
www.sureflash.com  
(206) 568-6633



Blue release liner is pulled, adhesive exposed and adhered to inside of window flange.

Use this ALTERNATE STEP 4 if Flashing is to be extended into the rough opening at the head.

1. Install 6" Flange Extension at head of window to inside of window flange. Adhesives are to fully cover flange. Apply at one corner, stretch across full width of window, cut to width of window, touch adhesive down at opposite side and compress lightly across full width. Finally firmly compress adhesive across full width of window.
2. Flap that extends to interior is to be cut even with window frame at both sides of the window.

Effective 06/30/09



Flashing Products Inc.  
2319 Federal Avenue East  
Seattle, Washington 98102  
[www.sureflash.com](http://www.sureflash.com)  
(206) 568-6633

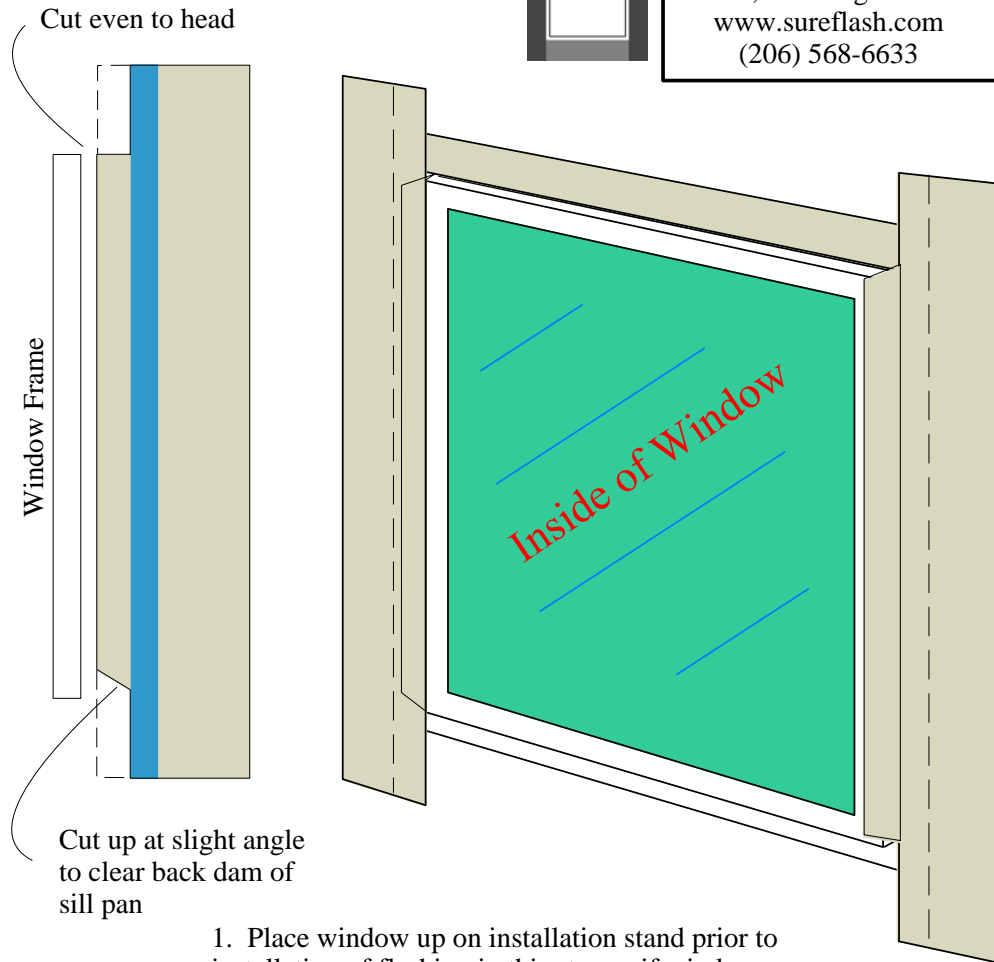

1. Place window up on installation stand prior to installation of flashing in this step or if window manufacture allows lay window on floor.
2. Make sure that flange is clean, dry and free of paper labeling. Trim away any excess plastic at corner welds.
3. Place 12 inch Inset Flashing across inner side of flange at each jamb of window. Touch adhesive at one end and then stretch across touching adhesive to flange on the other side. With light pressure compress adhesive to flange and then compress with firm pressure across full length. Extend past flange by 9 inches on top and bottom of window.
4. Cut away flap that extends into rough opening at the head of the window and at a slight angle at the sill.
5. If desired use small pieces of masking tape to hold flaps close to window frame until window is set in opening.

Effective 06/30/09

Use this ALTERNATE STEP 5 if Flashing is to be extended into the rough opening at the head.



Flashing Products Inc.  
2319 Federal Avenue East  
Seattle, Washington 98102  
www.sureflash.com  
(206) 568-6633

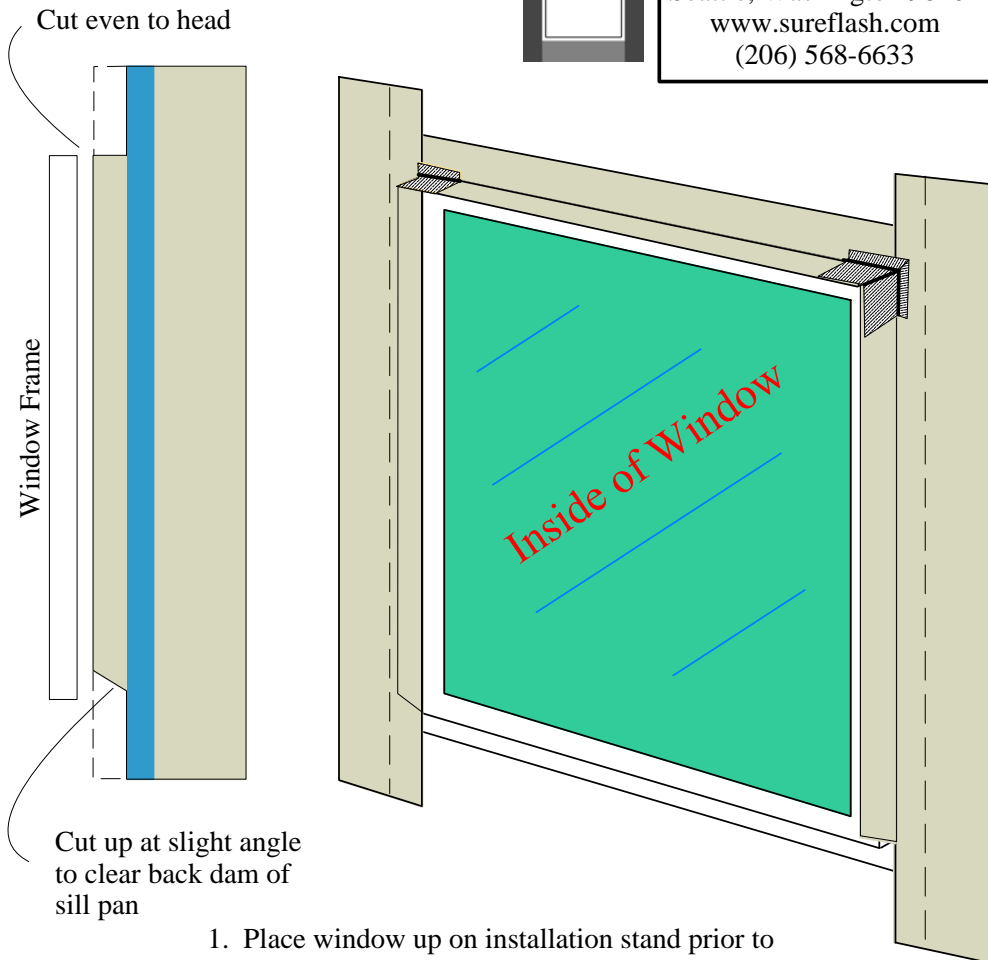

Cut up at slight angle to clear back dam of sill pan

1. Place window up on installation stand prior to installation of flashing in this step or if window manufacture allows lay window on floor.
2. Make sure that flange is clean, dry and free of paper labeling. Trim away any excess plastic at corner welds.
3. Place 12 inch Inset Flashing across inner side of flange at each jamb of window. Touch adhesive at one end and then stretch across touching adhesive to flange on the other side. With light pressure compress adhesive to flange and then compress with firm pressure across full length. Extend past flange by 9 inches on top and bottom of window.
4. Cut away flap that extends into rough opening at the head of the window and at a slight angle at the sill.
5. Tape each corner at head with 4" Sure Flex Tape. Tape is to extend across head and down jamb 3" and up onto flange 1".
6. If desired use small pieces of masking tape to hold flaps close to window frame until window is set in opening.

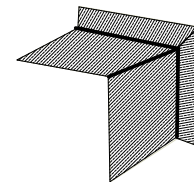

Sure Flex Tape

Effective 06/30/09



Flashing Products Inc.  
2319 Federal Avenue East  
Seattle, Washington 98102  
[www.sureflash.com](http://www.sureflash.com)  
(206) 568-6633

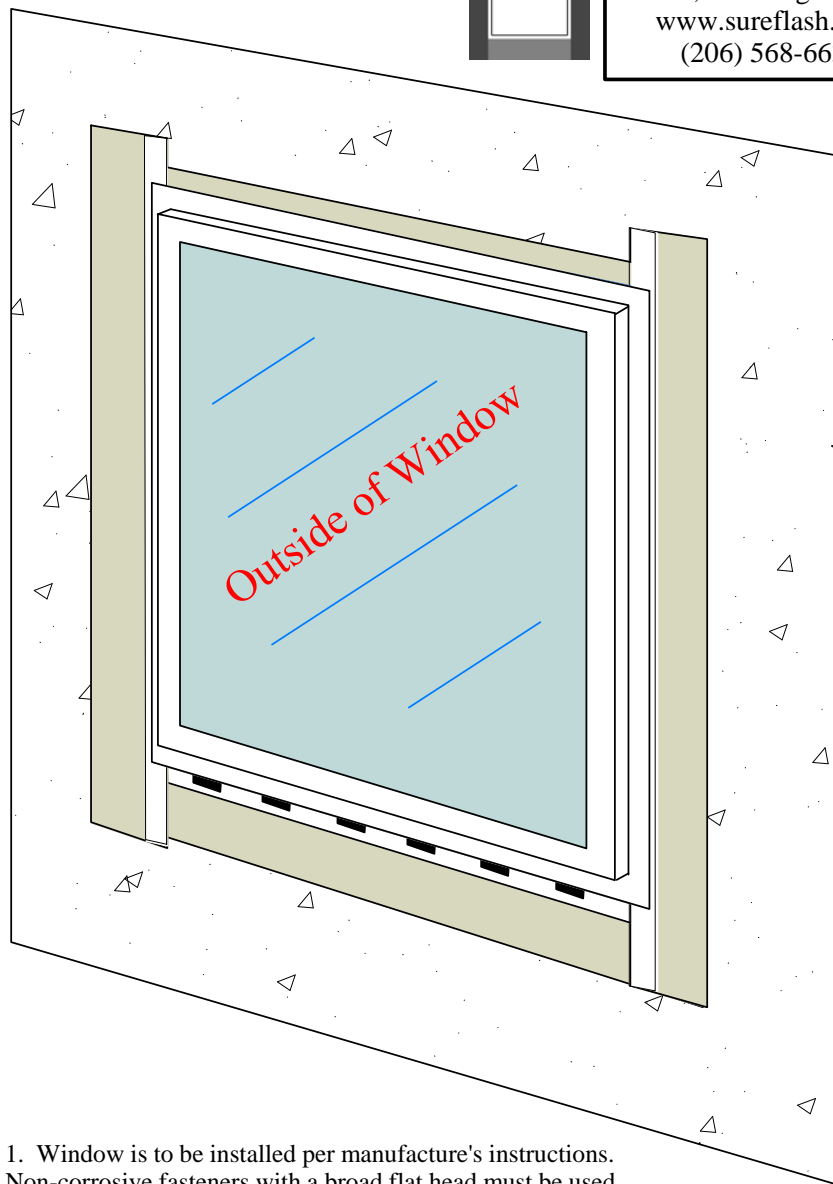

1. Window is to be installed per manufacture's instructions. Non-corrosive fasteners with a broad flat head must be used.
2. Determine required shims for leveling prior to placing window in rough opening. Shims are to be placed on top of existing shims.
3. Place 3/8" bead of polyurethane sealant full width of sill pan at back dam prior to installation of window. Caulk should overflow the full height of back dam and its upper leg that will contact window frame after window installation.
4. When window is inset to rough opening make sure flashing is positioned properly on exterior wall and that flaps extend into rough opening the full 3 inches.
5. When window has properly been positioned fasten at each side of jamb up from bottom at least 6 inches. Continue installation of fasteners per manufactures instructions. Head of window must be held in position directly by fasteners or an overlapping fender washer with fasteners just off the nailing flange at regular intervals across the width of the window.
6. Fully compress sill flange into adhesive and complete installation of remaining window fasteners.

Effective 06/30/09



Flashing Products Inc.  
2319 Federal Avenue East  
Seattle, Washington 98102  
www.sureflash.com  
(206) 568-6633

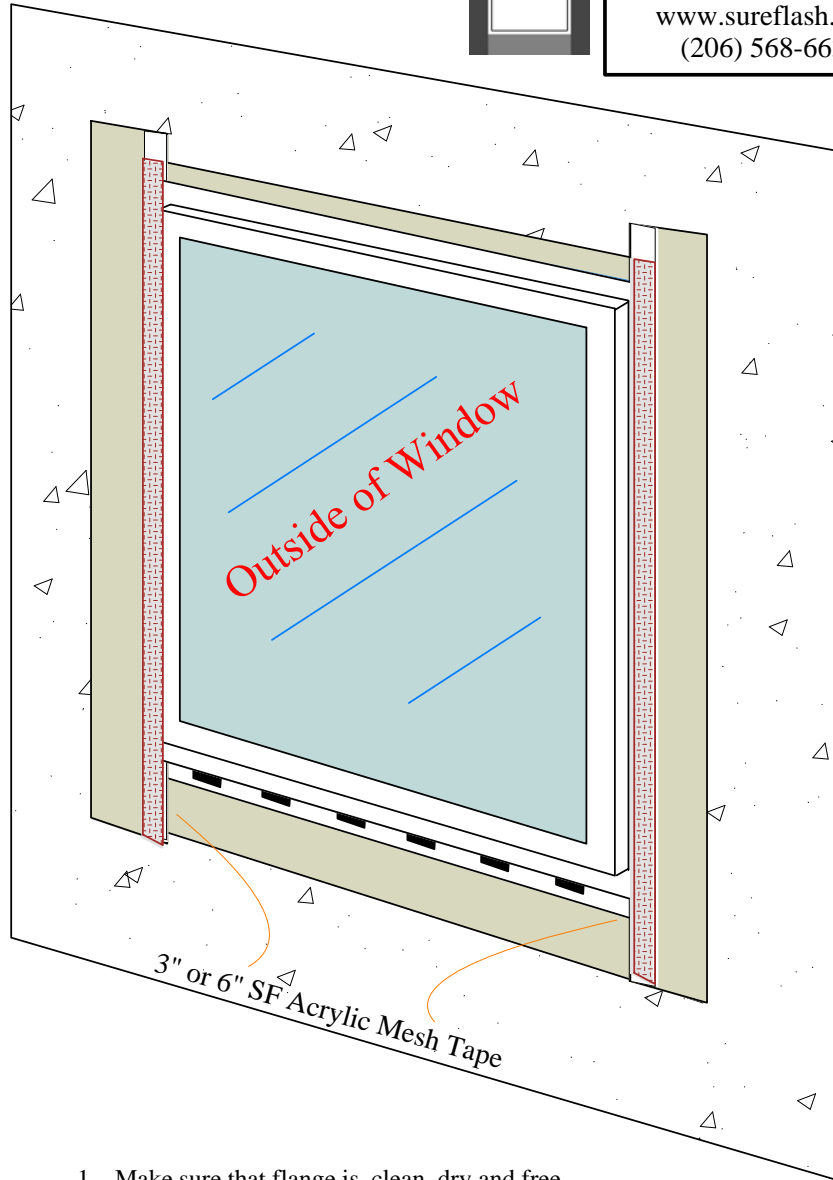

- 1.. Make sure that flange is clean, dry and free of paper labeling. Trim away any excess plastic at corner welds.
2. 3" SF Acrylic Mesh Tape over both jamb flanges & fully compress with back of utility knife and roller. Use 6" Tape for stucco in Coastal Climates. Tape is to extend from top of Flange Extension at window head to bottom of Sill Flashing. Tape is to seal Jamb Flashing to Sill Flashing the full width of the Sill Flashing.

Effective 06/30/09



Flashing Products Inc.  
2319 Federal Avenue East  
Seattle, Washington 98102  
www.sureflash.com  
(206) 568-6633

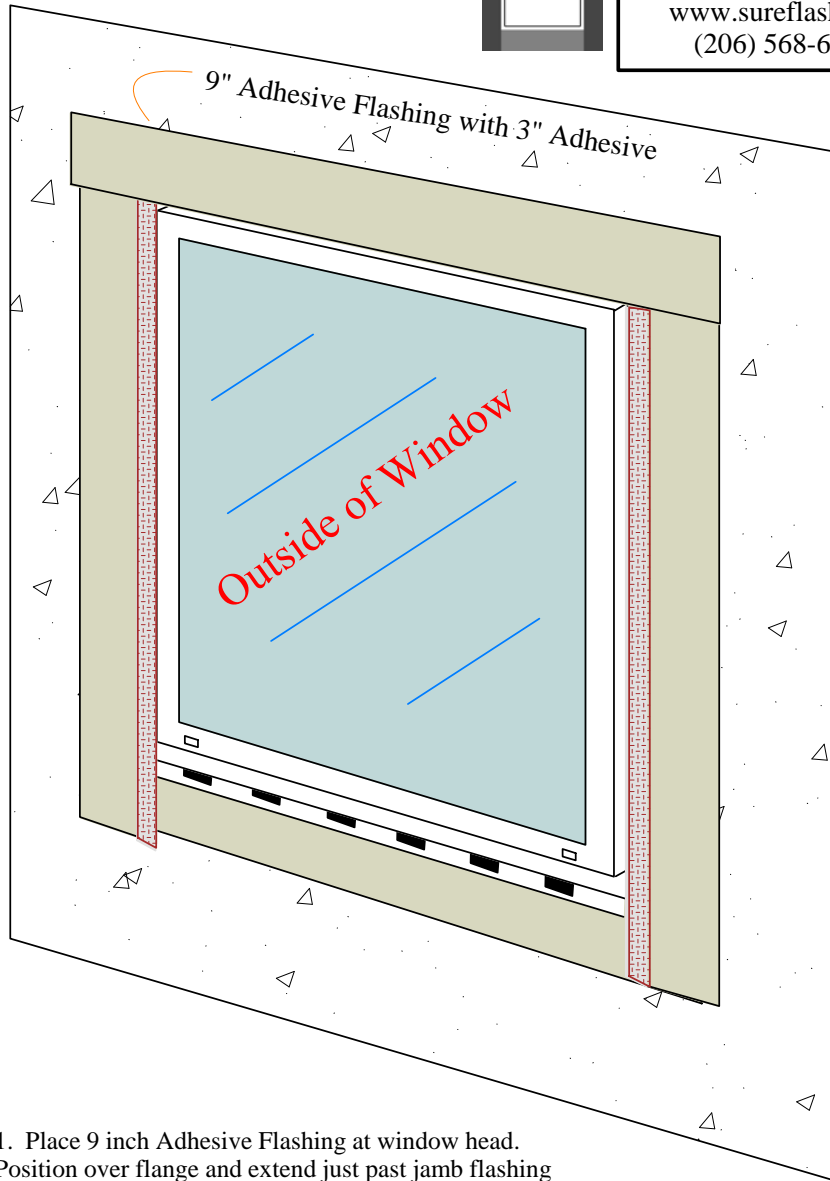

1. Place 9 inch Adhesive Flashing at window head. Position over flange and extend just past jamb flashing on each side of window. Pull tight and touch adhesive down on opposite side of window. Compress adhesive lightly full length and then fully compress with blunt tool (back of utility knife). Fasten through head Adhesive Flashing and Mesh Tape at window corner.
2. At exterior lap weather resistive barrier under flashing at sill and jambs and over flashing at head. Staples or fasteners for flashing and WRB should be placed only at perimeter of flashing. See FPI web site for details on WRB interface.
3. A sloped drip cap is to be installed above window by sider. Drip cap is to extend full width of window with end dams at both ends.



Flashing Products Inc.  
2319 Federal Avenue East  
Seattle, Washington 98102  
www.sureflash.com  
(206) 568-6633

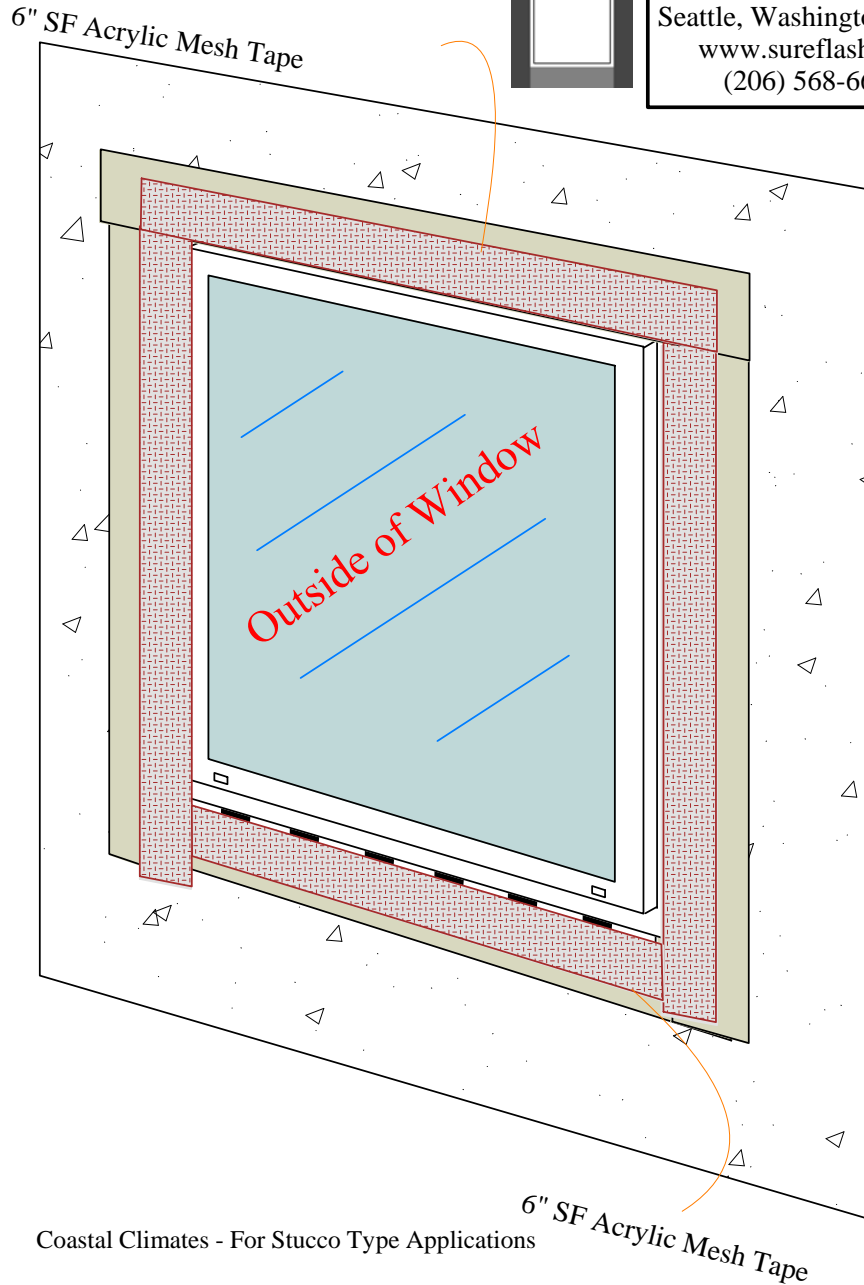

Coastal Climates - For Stucco Type Applications

1. Use 6" Acrylic or Polymeric Mesh Tape at jambs.
2. Overlay 6" Acrylic Mesh Tape across sill lapping onto jamb tape and foam tape of Sill Inset Flashing. Leave gap of 1/2" where foam remains exposed to for allow drainage.
3. Overlay 6" Acrylic Mesh Tape on top of Adhesive Flashing at head extending to outer edge of jamb tapes.

Effective 06/29/09



Flashing Products Inc.  
2319 Federal Avenue East  
Seattle, Washington 98102  
www.sureflash.com  
(206) 568-6633

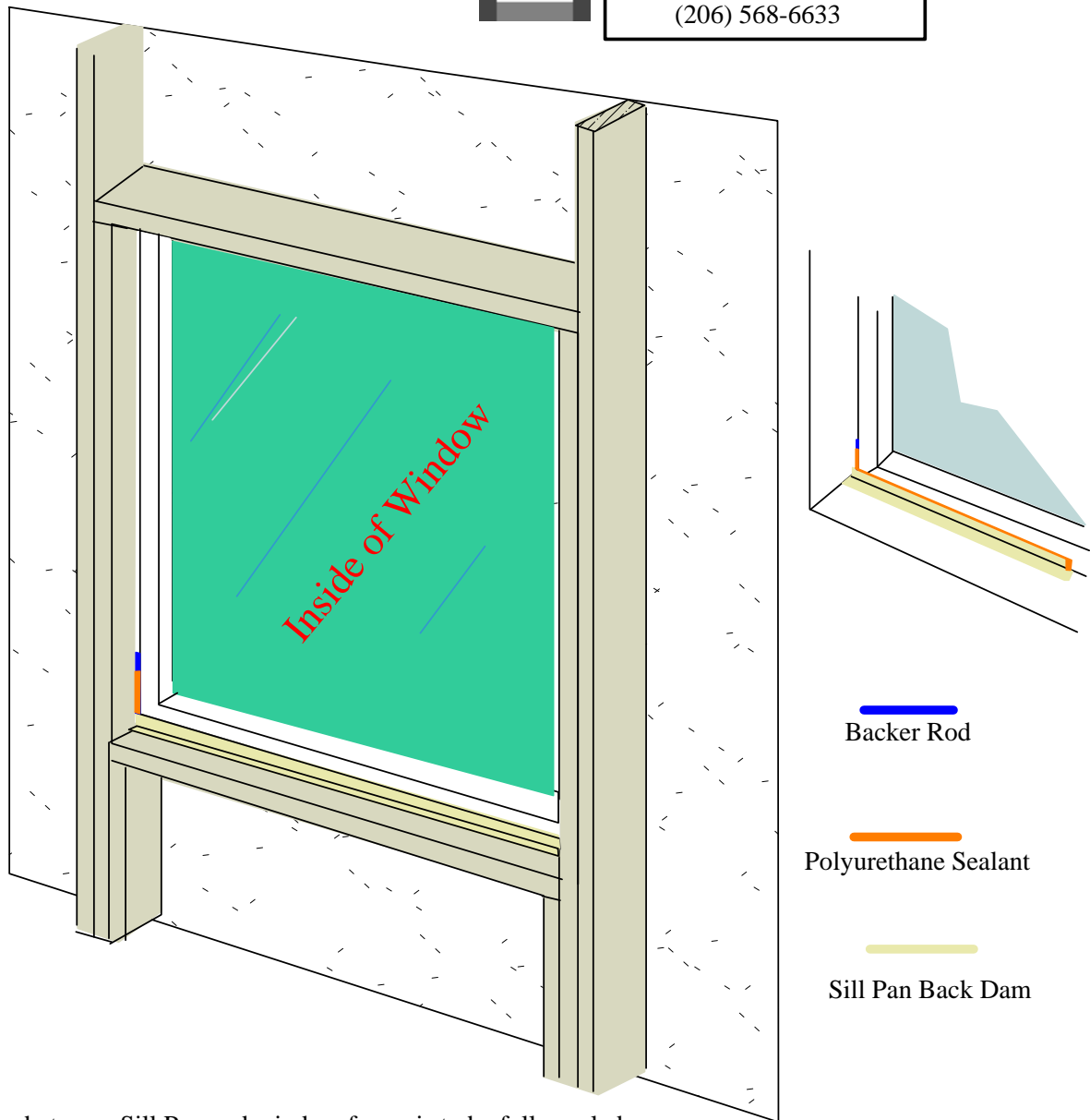

+ Gap between Sill Pan and window frame is to be fully sealed with caulk. Pan inset may be adjusted slightly by removing pan screws and pushing in on pan prior to caulk having set. Reset screws until caulk has fully cured (10 - 14 days for many sealants. Nailing strip is scored to break off and may be removed after caulk has fully cured.

1. Seal full perimeter of window with SF Air Seal according to instructions  
or for backer rod and caulk
2. At interior jamb & head air seal full perimeter of window at interface of flashing, window inner frame and framing (typically completed by insulation installer).
3. Rough opening gap is to be filled with backer rod leaving a minimum 1/4" deep cavity to be filled with polyurethane sealant.
4. If allowed by window manufacture low energy expanding foam may be used to air seal the jambs and head rough opening gap.
5. A complete perimeter air seal is required for all Sill Pan installations and is to be installed prior to field water pressure test.

# Sure Flash - Ganged Windows

Effective 09/30/09

Flashing Products Inc.  
2319 Federal Avenue East  
Seattle, Washington 98102  
www.sureflash.com  
(206) 568-6633



Install this window in normal manner.  
Pull release liner from foam tape at head of lower window after installing Sill Flashing. Compress Sill Flashing into place and cut away excess flashing around window below.

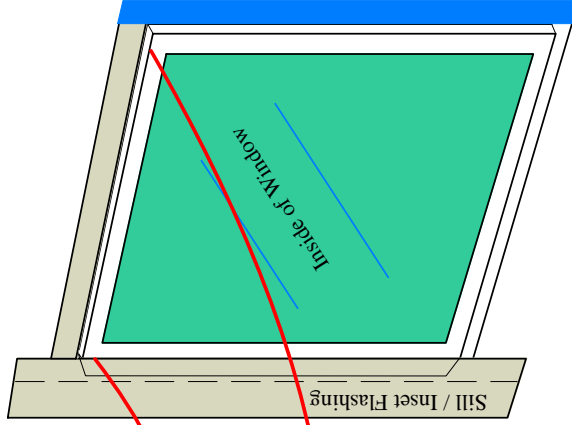
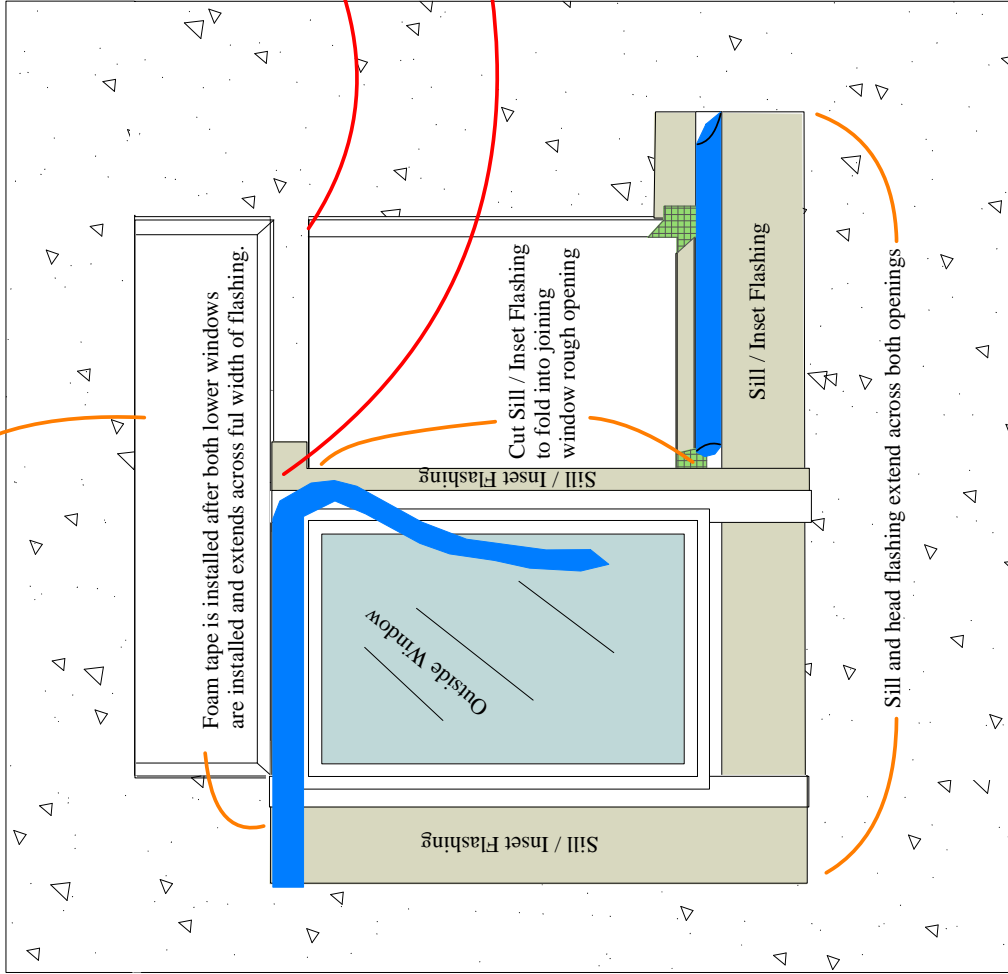

Ganged Windows are to be completed as other windows with the following exceptions:

1. Lower window is to be fully installed before windows above.
2. Horizontal flashing is to be installed across both windows.
3. If the windows are further than 6" apart install in normal manner at jambs. Sill and head flashing may still cross both windows.
4. If the windows are closer than 6" together then foam tape is to be applied to the inside of the window flange of the second window. The flashing of the first installed window is to be folded into the rough opening of the second window.
5. When the second window is installed so that when installed the foam tape seals to the adjoining windows flashing material.
6. The window is to be secured on the outside flange and in one location across the sill after alignment and before pulling the foam tape release liner from under the flange. Fully compress flange adhesive into flashing after release liner has been removed.
7. Tape is also applied across the head of the window for the sill flashing of the window above to seal into.